

## MODEL 4500 LOWERATOR-RINSER

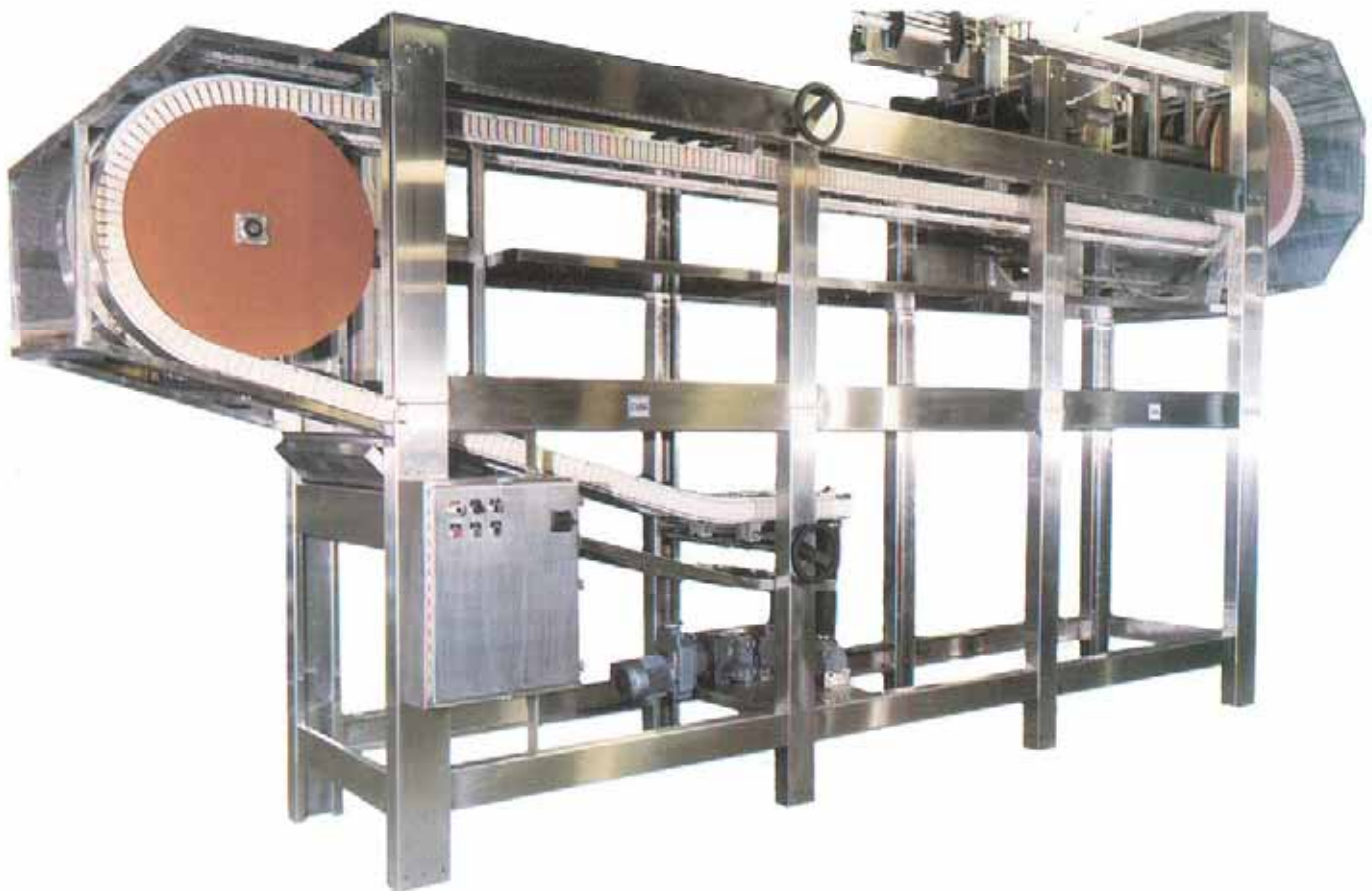

**THE CHSC MODEL 4500 LOWERATOR-RINSER** HAS MANY NEW FEATURES THAT MAKE THIS UNIT SUPERIOR TO ANY OTHER. DESIGNED SPECIFICALLY FOR THE BEVERAGE INDUSTRY, THE RINSER WILL ACCOMMODATE PLASTIC OR GLASS CONTAINERS FROM 500 ML. UP TO THREE LITERS, AT SPEEDS APPROACHING 1000 CONTAINERS PER MINUTE.

THE RINSER UNIT IS BUILT WITH MODULAR STAINLESS STEEL CONSTRUCTION AND HAS ALL STAINLESS STEEL SHAFTING WITH NICKEL PLATED BEARINGS. THE WEARSTRIPS ARE ALL UHMW AND THE SPLASH SHIELDS ARE LEXAN.

SPECIAL FEATURES INCLUDE SOFT TOUCH FDA APPROVED GRIPPER CHAIN, TAPERING WEARSTRIPS FOR GENTLE RELEASE OF THE

CONTAINERS, PNEUMATICALLY ACTIVATED CHAIN TAKE-UPS FOR LESS MAINTENANCE, QUICK HANDWHEEL ADJUSTMENT FOR THE VARIOUS PRODUCT SIZES, AND SOLENOID CONTROLLED WATER RINSE THAT CAN BE ACTIVATED BY THE PRODUCT FLOW.

THE RINSER UNIT CAN BE PROVIDED WITH CONVEYOR STUB INFEED AND DISCHARGE PIECES OR WILL ACCOMMODATE ALMOST ANY TYPE OF AIR CONVEYOR READILY.

OTHER OPTIONS INCLUDE A NEMA 4X ALL STAINLESS STEEL CONTROL PANEL WITH ALLEN-BRADLEY COMPONENTS MOUNTED AND PRE-PIPED ON THE UNIT. CENTRALLY LOCATED GREASE MANIFOLDS CAN ALSO BE PROVIDED.

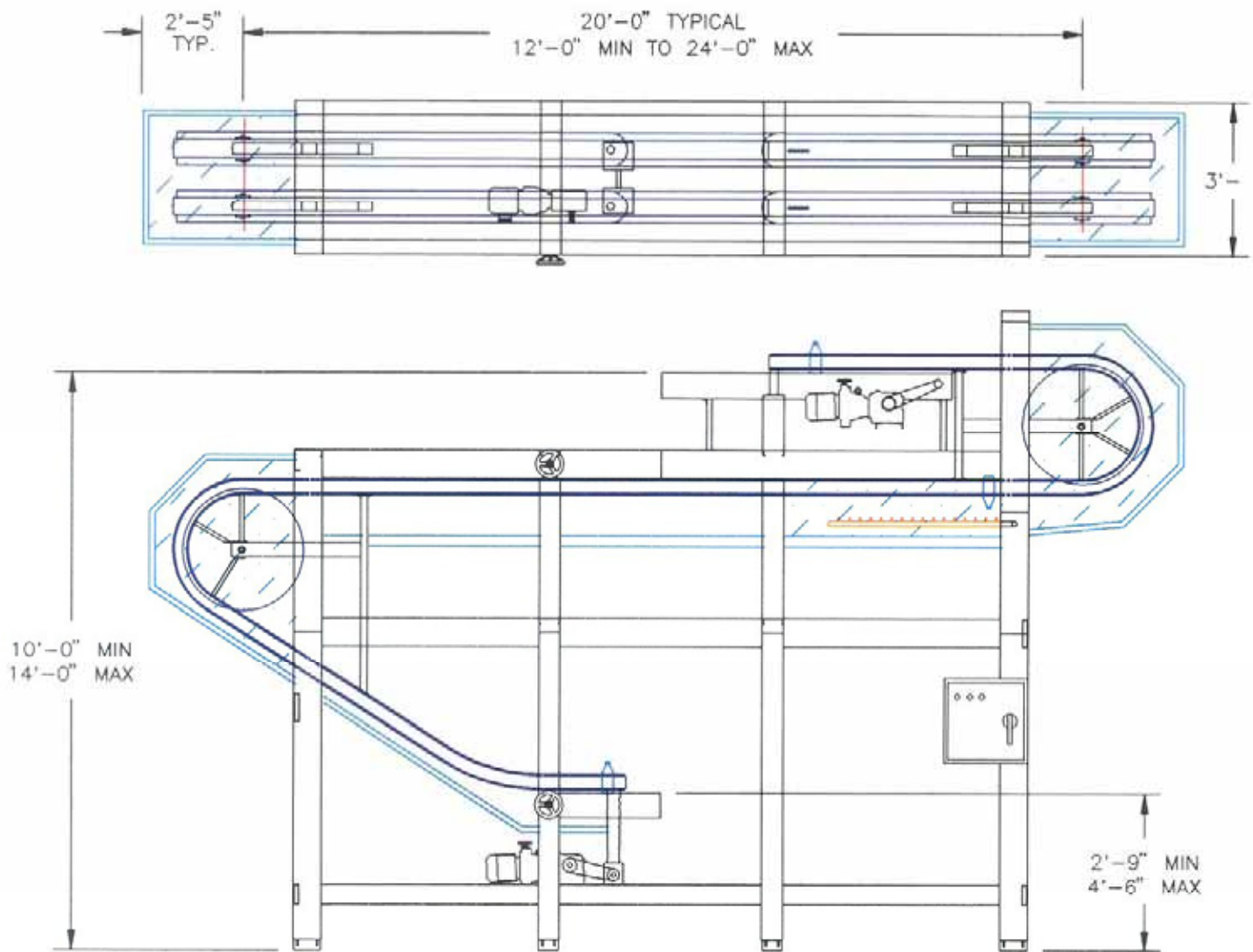

## MODEL 4500 LOWERATOR-RINSER

### STANDARD SPECIFICATIONS:

**CONSTRUCTION:** 7 AND 11 GA. STAINLESS STEEL FRAME AND ALL S.S. SHAFTING AND HARDWARE.

**CONVEYOR CHAIN:** 3/4" WIDE 1873 CHAIN WITH WHITE PLASTIC FEATHER TOUCH FDA APPROVED WEDGE GRIPPERS ON A NO. 60 S.S. ROLLER CHAIN BASE.

**WEAR STRIPS:** 3/4" THICK UHMW STRIPS.

**END DISCS:** 3/4" THICK WATER RESISTANT PHENOLIC PLASTIC.

**DRIVE PARTS:** 3 HP EURODRIVE VARIMOT VARIABLE SPEED MOTOR AND (2) HUB CITY RIGHT ANGLE GEAR BOXES WITH DOUBLE U-JOINT CONNECTED DRIVEN SHAFTS, NO. 60 ROLLER CHAIN AND A MECHANICAL TORQUE LIMITER.

**PRODUCT SIZE ADJUSTMENT:** BOTH SIDES OF THE SIDE GRIP CONVEYORS SLIDE ON EIGHT PRECISION SHAFTS AND ARE CONNECTED VIA NO. 40 ROLLER CHAIN AND SPROCKETS TO A UPPER & LOWER ADJUSTING HAND WHEEL.

**WATER SPRAY:** ALL STAINLESS STEEL PIPING WITH EIGHT STRAIGHT STREAM NOZZLES AND SOLENOID CONTROLLED FEED. WATER USAGE IS 5 GPM @ 60 PSI.

**GUARDS:** DRIVE GUARDS ARE OF STAINLESS STEEL CONSTRUCTION AND WATER SPRAY SHIELDS ARE OF REMOVABLE LEXAN.

### OPTIONAL EQUIPMENT:

INFED & DISCHARGE CONVEYOR STUBS WITH DRIVE, CONVEYOR TYPE TO SUIT.

CONTROL PANEL, NEMA 4X SS. PANEL WITH ALLEN BRADLEY COMPONENTS, PRE-WIRED AND FACTORY TESTED.

CENTRALLY LOCATED LUBE MANIFOLD.