



**CONTAINER HANDLING SYSTEMS CORP.**

621 E. PLAINFIELD RD. COUNTRYSIDE, IL 60525

[WWW.CONTAINERHANDLINGSYSTEMS.COM](http://WWW.CONTAINERHANDLINGSYSTEMS.COM)



## **BI-DIRECTIONAL ACCUMULATION TABLE**

An accumulation table is a must for every production line. When placed between two operations, it allows the up-stream operation to continue in the event the down-stream operation has momentary stoppages. The bi-directional accumulator allows the most accumulation per square foot than any other style accumulator. In addition to being space effective the containers do not move on the product chain while being

accumulated. This reduces container pressure and damage.

Container Handling Systems Corp. accumulation tables offer a wide range of construction, accessories, sizes and product chains to fit most applications. Our modular style frame allows easy handling and assembly in your plant.

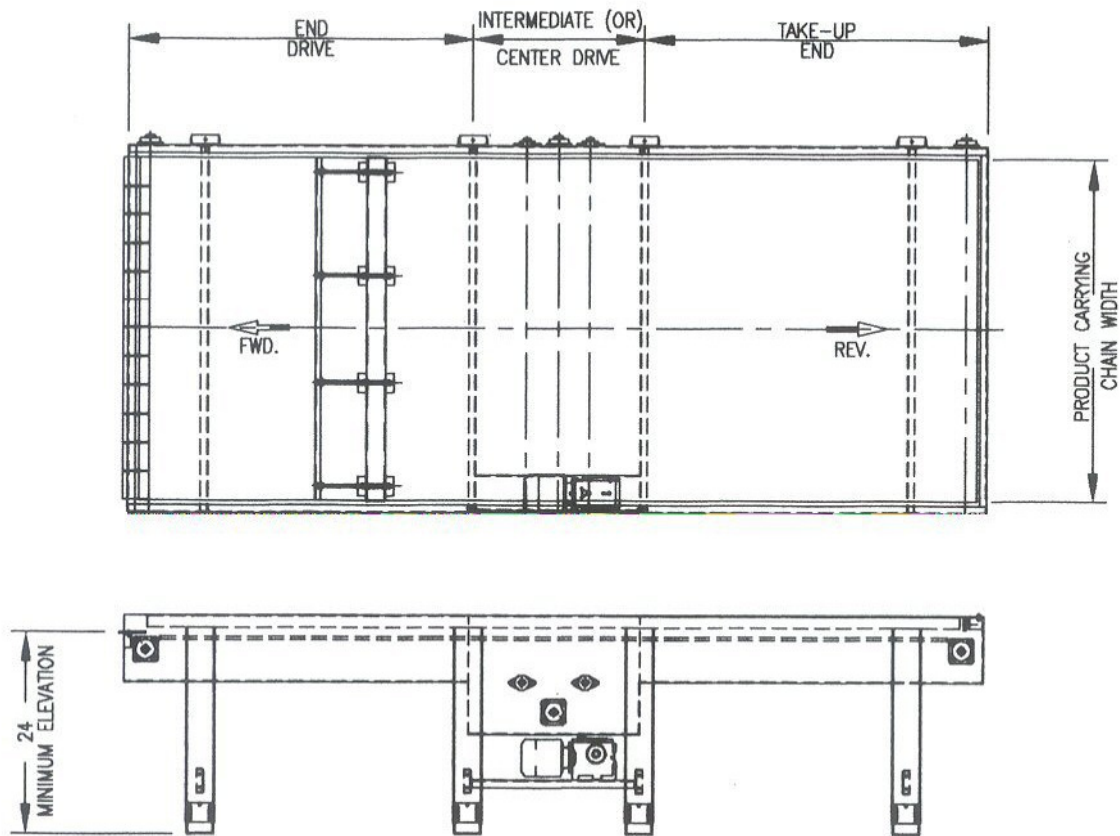

NARROW WAY = 36", 48", 60" & 72" CHAIN WIDTHS  
 WIDE WAY = 84", 96" & 120" CHAIN WIDTHS

NARROW WAY TABLE MODULES = 10'-0" LENGTHS  
 WIDE WAY TABLE MODULES = 5'-0" LENGTHS

## SPECIFICATIONS

**OUTER FRAME PANELS:** 11 Ga. painted mild steel or polished stainless steel.

**INNER FRAME:** 7 Ga. formed channels, painted mild steel or stainless steel.

**WEAR STRIPS:** 1/2" or 1 1/2" formed "C" channel with UHMW plastic covers.

**DRIVE AND IDLER SHAFTS:** 1 1/2" dia. and 2" dia. C.R.S. or stainless steel.

**SIDE RAILS:** Same styles available as adjoining conveyors.

**FLOOR SUPPORTS:** 6" formed 11 Ga. channel with adjusters, painted mild steel or polished stainless steel, located at each splice point.

**PRODUCT CARRYING CHAIN:** All styles and manufacturers of plastic mat top chains.

**DRIVE ASSEMBLIES:** Hydraulic or electric drives available, end drive or center drive locations, No. 60 drive sprockets with mild steel or polished stainless steel guards, side mounted motor bases.

**CONTROL PANEL (Optional):** NEMA-12 or NEMA-4 enclosures, one A-B reversing starter, fused with heaters, fused main disconnect, operator control station. Four pressure bar control switches with time delays.